

## Metrik / M (Sağ Yön - Sol Yön) Metrik İNCE Diş Pafta Lokması

Sipariş Kod PLD - R / L	d1 x P M.Diş	d2 f9	h1 mm
C223. M17.15	M 17 x 1.5	45	14
C223. M17.1	M 17 x 1		
C223. M18.2	M 18 x 2		
C223. R/L M18.15	M 18 x 1.5		
C223. R/L M18.125	M 18 x 1.25		
C223. R/L M18.1	M 18 x 1		
C223. R M19.15	M 19 x 1.5		
C223. R M20.2	M 20 x 2		
C223. R/L M20.15	M 20 x 1.5		
C223. R/L M20.1	M 20 x 1		
C223. R M21.15	M 21 x 1.5		
C223. R M22.2	M 22 x 2		
C223. R/L M22.15	M 22 x 1.5		
C223. R M22.125	M 22 x 1.25		
C223. R/L M22.1	M 22 x 1		
C223. R M23.15	M 23 x 1.5		
C223. R/L M24.2	M 24 x 2		
C223. R/L M24.15	M 24 x 1.5		
C223. R M24.125	M 24 x 1.25		
C223. R M24.1	M 24 x 1		
C223. R M25.2	M 25 x 2		
C223. R M25.15	M 25 x 1.5		
C223. R M25.1	M 25 x 1		
C223. R M26.2	M 26 x 2		
C223. R M26.15	M 26 x 1.5		
C223. R M26.1	M 26 x 1		
C223. R/L M27.2	M 27 x 2		
C223. R M27.15	M 27 x 1.5		
C223. R M27.1	M 27 x 1		
C223. R M28.2	M 28 x 2		
C223. R M28.15	M 28 x 1.5		
C223. R M28.1	M 28 x 1		
C223. R M29.15	M 29 x 1.5		
C223. R M30.3	M 30 x 3		
C223. R M30.25	M 30 x 2.5		
C223. R/L M30.15	M 30 x 2		
C223. R/L M30.15	M 30 x 1.5		
C223. R M30.1	M 30 x 1		
C223. R M32.3	M 32 x 3		
C223. R M32.2	M 32 x 2		
C223. R M32.15	M 32 x 1.5		
C223. R M33.3	M 33 x 3		
C223. R M33.2	M 33 x 2		

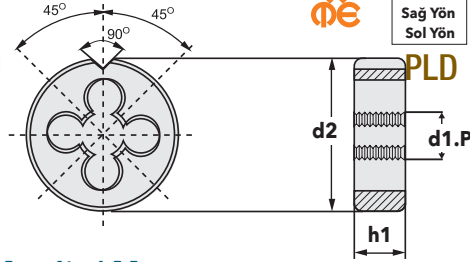

## Metrik / M (Sağ Yön - Sol Yön) Metrik İNCE Diş Pafta Lokması

Kod MTE B001100	Sipariş Kod PLD - R / L	d1 x P M.Diş	d2 f9	h1 mm
-	C223. R M3.035	M 3 x 0.35	20	5
-	C223. R M3.5.035	M 3.5 x 0.35		
-	C223. R M4.05	M 4 x 0.5		
-	C223. R M4.035	M 4 x 0.35		
-	C223. R M4.5.05	M 4.5 x 0.5		
-	C223. R/L M5.05	M 5 x 0.5		
-	C223. R M5.5.05	M 5.5 x 0.5		
-	C223. R M6.05	M 6 x 0.5		
MTE 30604	C223. R/L M6.075	M 6 x 0.75		
-	C223. R M7.075	M 7 x 0.75		
MTE 30805	C223. R/L M8.1	M 8 x 1		
-	C223. R/L M8.075	M 8 x 0.75		
-	C223. R M8.05	M 8 x 0.5		
-	C223. R M9.1	M 9 x 1		
MTE 31000	C223. R/L M10.125	M 10 x 1.25		
MTE 31005	C223. R/L M10.1	M 10 x 1		
-	C223. R M10.075	M 10 x 0.75		
-	C223. R M10.05	M 10 x 0.5		
-	C223. R M11.1	M 11 x 1		
MTE 31206	C223. R M12.15	M 12 x 1.5		
MTE 31200	C223. R M12.125	M 12 x 1.25		
MTE 31205	C223. R/L M12.1	M 12 x 1		
-	C223. R M12.075	M 12 x 0.75		
-	C223. R M13.1	M 13 x 1		
MTE 31406	C223. R/L M14.15	M 14 x 1.5		
MTE 31400	C223. R/L M14.125	M 14 x 1.25		
MTE 31405	C223. R M14.1	M 14 x 1		
-	C223. R M14.075	M 14 x 0.75		
-	C223. R M15.1	M 15 x 1		
MTE 31606	C223. R/L M16.15	M 16 x 1.5		
-	C223. R M16.125	M 16 x 1.25		
MTE 31605	C223. R/L M16.1	M 16 x 1		

\* Diğer Ara Dişleri Firmamızdan Sorunuz

C 223 : HSS DIN223 Ekonomik PLD Sağ Diş Pafta...  
C223 / L : HSS DIN223 Ekonomik PLD Sol Diş Pafta...

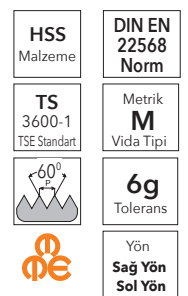

## Metrik / M (Sağ Yön - Sol Yön) NORMAL Vidalı Pafta Lokması

El ve Otomatik Makinalarda Kullanılır, Ewijk Ağzı Bileme Özelliğiyle Temiz Vida Dişi Elde Edilir. Tüm Çelik Türlerinde Kullanılabilir (Prinç Malzeme için Özel Kesme Geometrilii)

Kod MTE B001100	Sipariş Kodu PLD - R / L	d1 x P M.Diş	d2 f9	h1 mm
MTE 20200	C223. R/L M2	M 2 x 0.4	16 mm	5
MTE 20250	C223. R M2.5	M 2.5 x 0.45		
MTE 20300	C223. R/L M3	M 3 x 0.5	20 mm	5
MTE 20350	C223. R M3.5	M 3.5 x 0.6		
MTE 20400	C223. R/L M4	M 4 x 0.7	20 mm	7
MTE 20500	C223. R/L M5	M 5 x 0.8		
MTE 20600	C223. R/L M6	M 6 x 1	25 mm	9
MTE 20700	C223. R/L M7	M 7 x 1		
MTE 20800	C223. R/L M8	M 8 x 1.25		
MTE 20900	C223. R M9	M 9 x 1.25	30	11
MTE 21000	C223. R/L M10	M 10 x 1.5		
MTE 21200	C223. R/L M12	M 12 x 1.75	38 mm	14
MTE 21400	C223. R/L M14	M 14 x 2		
MTE 21600	C223. R/L M16	M 16 x 2	45 mm	18
MTE 21800	C223. R/L M18	M 18 x 2.5		
MTE 22000	C223. R/L M20	M 20 x 2.5	55 mm	22
MTE 22200	C223. R/L M22	M 22 x 2.5		
MTE 22400	C223. R/L M24	M 24 x 3		
MTE 22700	C223. R/L M27	M 27 x 3	65 mm	25
MTE 23000	C223. R/L M30	M 30 x 3.5		
MTE 23300	C223. R/L M33	M 33 x 3.5		
MTE 23600	C223. R/L M36	M 36 x 4	75 mm	30
MTE 23900	C223. R M39	M 39 x 4		
MTE 24200	C223. R M42	M 42 x 4.5	90 mm	36
MTE 24500	C223. R M45	M 45 x 4.5		
MTE 24800	C223. R M48	M 48 x 5		
MTE 25200	C223. R M52	M 52 x 5		

Siparişlerinizde Termin Sorunuz !

Örnek Sipariş: C 223 / R Sağ Diş C223 / L Sol Diş  
C 223 / R M16 x 2 Sağ Diş = C223 / L M16 x 2 Sol Diş